

Directions to the Nordic Cochrane Centre, The Panum Institute, Rigshospitalet Dept. 3343

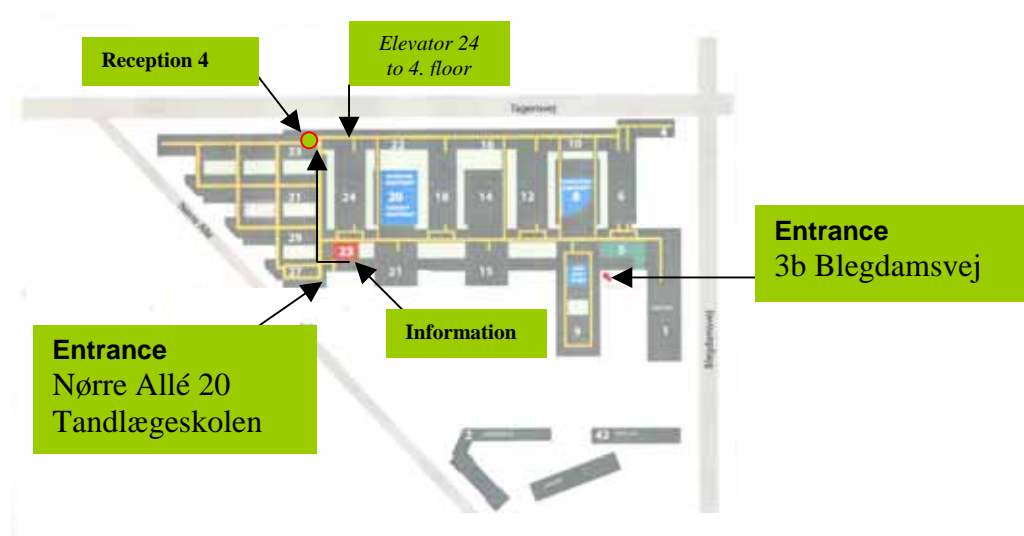

There are two entrances (the first one is the closest):

1. Directions through Tandlægeskolen, 20 Nørre Allé:

- Use the entrance, 20 Nørre Allé
- After the revolving door, keep to the left, and continue down the long walking area towards 'Reception 4'
- At 'Reception 4' turn right, go through the blue door and take the elevator to the 4th floor. Now see section 3, "On 4th floor", below.

2. Directions through 3b Blegdamsvej:

- Enter through the revolving door at the main entrance at 3b Blegdamsvej (at the covered area full of parked bicycles).
- Go up the spiral staircase next to the Information↑ sign in the reception hall.
- At the top of the stairs, proceed up the concrete steps on your right to the main hall.
- Go left in the main hall – there is a sign with number 12 in front of you.
- Continue until you reach number 21 and a white ceramic wall with coloured dots on your right.
- At the end of the ceramic wall, turn right down the passage (so you have windows on your left hand and pass the rooms 'Victor Haderup Auditorium' and 'Adolph Hannover Auditorium' on your right).
- Go through the glass door at the end of the passage, turn left, and go through the orange door. You are now in a hall with elevators. Take an elevator to the 4th floor.

3. On 4th floor:

- Go through the blue door with the sign 'bygning 33, etage 4'.
- Walk down the hall, passing through four sets of orange doors. The fifth orange door is the entrance to the Nordic Cochrane Centre.